

# HAND HELD CASES

## 2955 Series Keyfob

A range of keyfob enclosures dedicated to RF activated mobile applications such as hand-held transmitters and manual control units. The snap-fit design allows an uncomplicated and secure assembly.



Round Keyfobs (Serie 21)  
2955-20

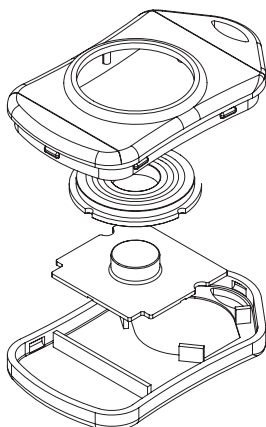

Ergo Keyfobs (Serie 22)  
2955-40

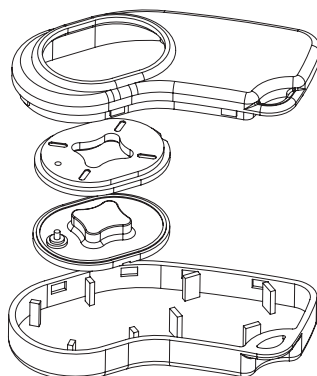

Eco Keyfob (Serie 2596)  
2956

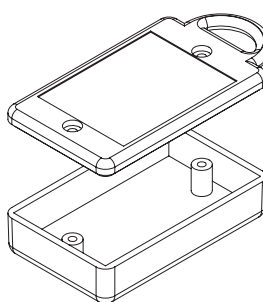

Eco Keyfobs (Serie 2597)  
2957

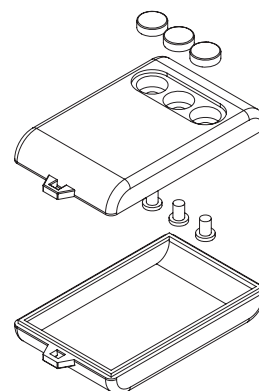

### 2955-40 Series Ergo Keyfobs (Serie 22)

Ergonomically shaped ABS keyfobs with 1-5 rubber buttons and clear silicone LED window.

- Moulded in ABS
- Snap-fit assembly of lid and base
- 1 to 5 ergonomically shaped rubber buttons with contact pads
- Base incorporates a separate enclosed battery compartment for coin cells
- Eyelet for key-ring
- Clear silicone LED window



#### SPECIFICATION

Materials	Lid, base & adaptor ABS Push buttons silicone
Standard colours	Lid, base and adaptor black similar to RAL 9004 Push buttons light grey similar to RAL 7037
Standard unit includes	Lid & base Push-button insert Button adaptor

BLACK	DESCRIPTION
2955-40R-1	1 Button
2955-40R-2	2 Button
2955-40R-3	3 Button
2955-40R-4	4 Button
2955-40R-5	5 Button

